

# Dawn Trashwheels Row Cleaners Assembly and Operation Manual

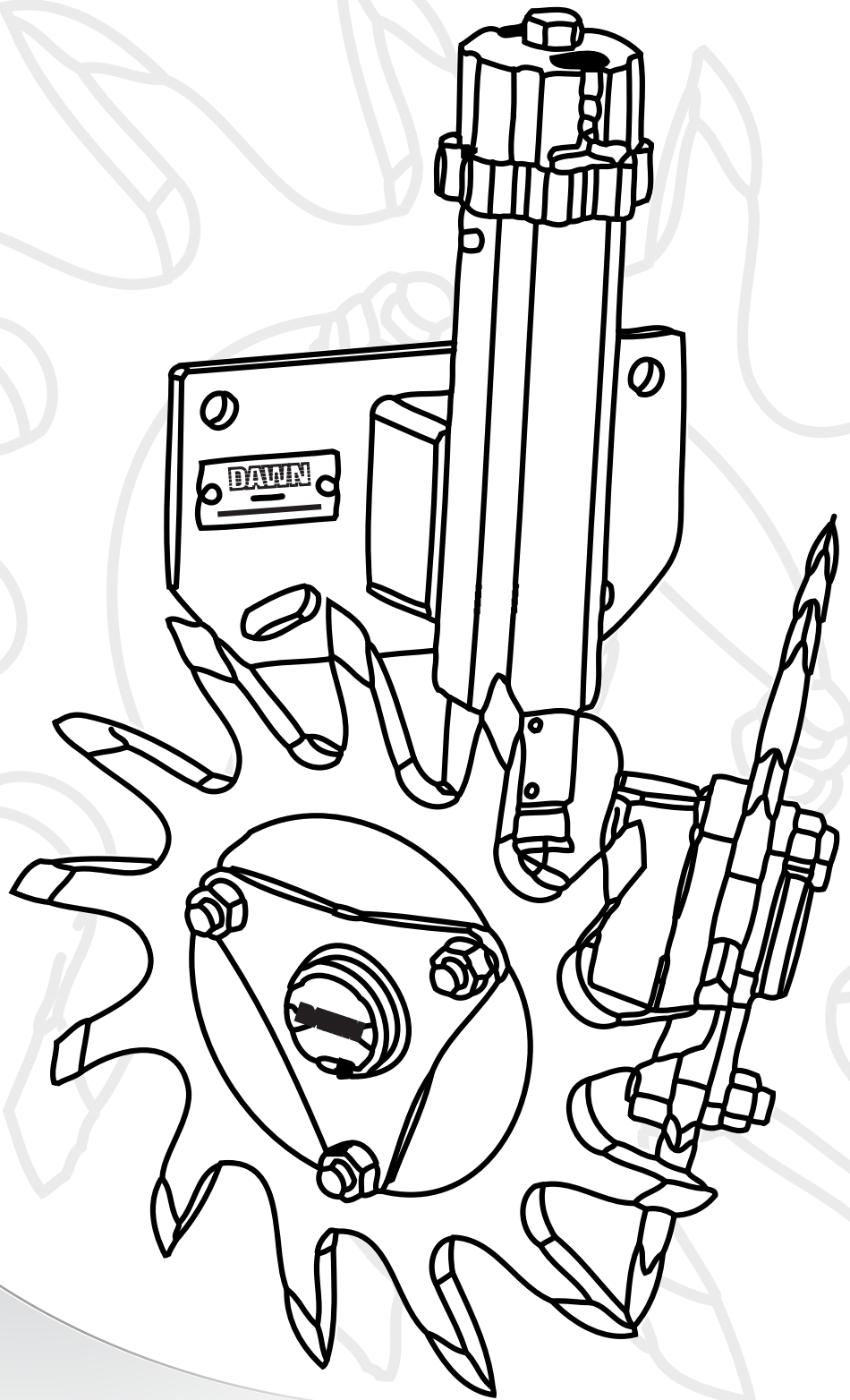

**DAWN**®

## Bolt Torque Chart

This table is based on torque requirements  
(in ft./lb.) for Grade 5 bolts.

Bolt Diameter	Minimum Torque	Maximum Torque
1/4"	9	11
5/16"	17	20
3/8"	35	42
7/16"	54	64
1/2"	80	96
9/16"	110	132
5/8"	150	180
3/4"	270	324
7/8"	400	480
1"	580	696
1 1/8"	800	880
1 1/4"	1120	1240
1 3/8"	1460	1680
1 1/2"	1940	2200

Note: For self-locking nuts, increase the torque requirements by 15%

**1**

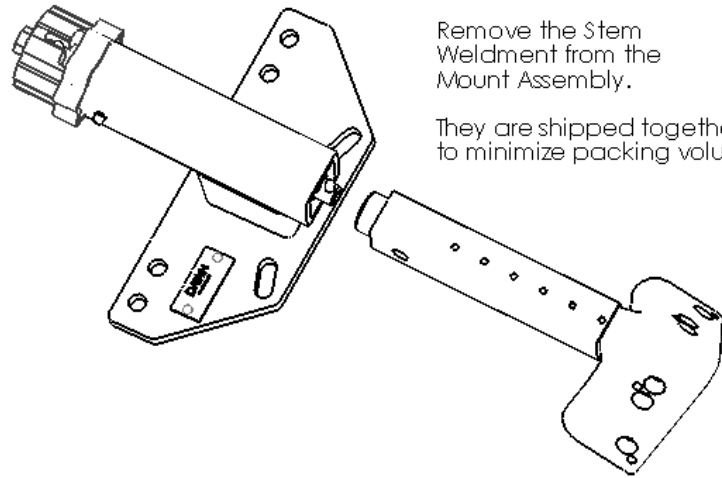

Step 1

Remove the Stem Weldment from the Mount Assembly.

They are shipped together to minimize packing volume.

**2**

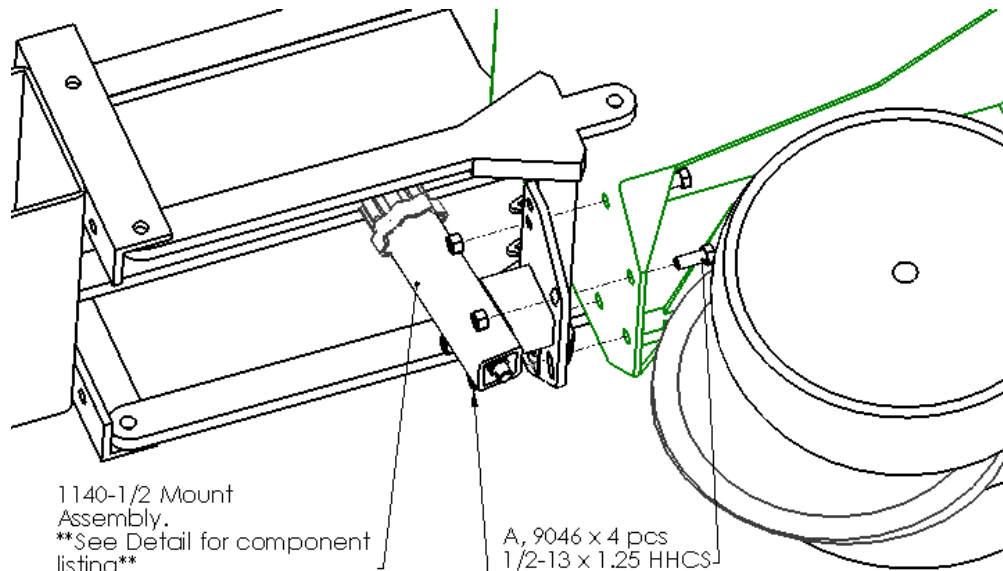

1140-1/2 Mount Assembly.  
\*\*See Detail for component listing\*\*

Step 2

Bolt the mount assembly to the front face of the planter.

A, 9046 x 4 pcs  
1/2-13 x 1.25 HHCS

A, 9007 x 4 pcs  
1/2-13 spin lock nut

A=9056, mount hardware kit

# 2 CASE

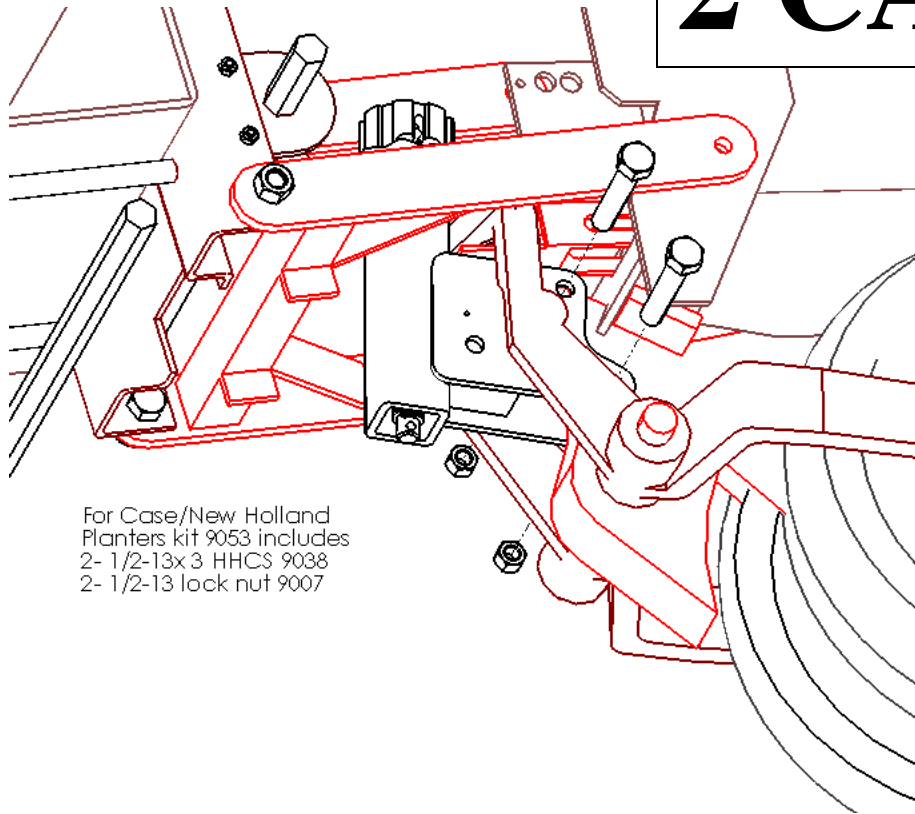

For Case/New Holland  
Planters kit 9053 includes  
2- 1/2-13x 3 HHCS 9038  
2- 1/2-13 lock nut 9007

## 3-1

### Step 3, Detail 1

Bolt the TrashWheels to the hubs. Each Row unit requires two such assemblies.

**\*\*Caution\*\***  
See Step 3, Detail 2  
for caution on SuperCap  
assembly

A=9115, Hub Hardware kit

B=400 014, all components  
marked "B" are included  
in the 400 014 assembly.

**\*\*See Detail for internal  
components\*\***

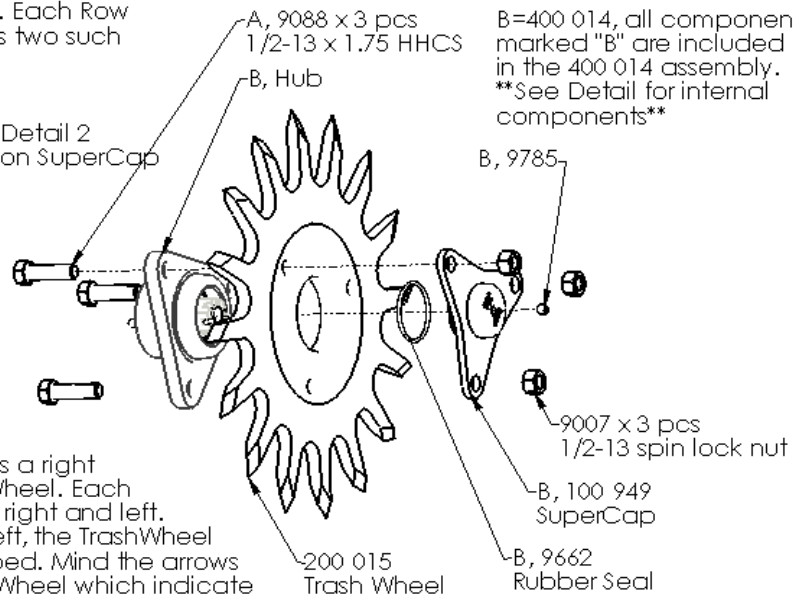

Shown here is a right  
hand TrashWheel. Each  
row needs a right and left.  
To make a left, the TrashWheel  
is simply flipped. Mind the arrows  
on the TrashWheel which indicate  
direction of rotation.

Step 3, Detail 2

3-2

1. Apply a small amount of grease to the perimeter of the rubber seal.

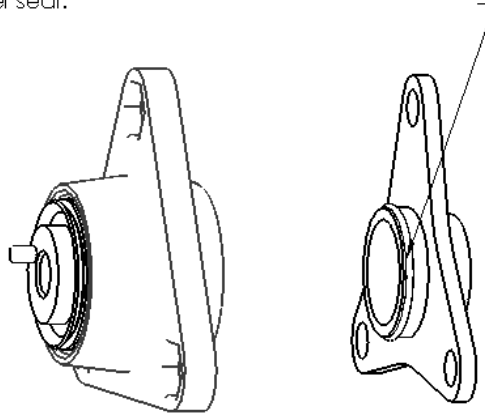

2. **\*\*Very Important\*\***

Do not screw in the hex plug until after the SuperCap has been bolted onto the assembly. The rubber seal makes an air tight seal. If you have the plug screwed in and try to insert the SuperCap, you will likely break the rubber seal and make it ineffective. Taking care in this step will greatly extend the life of your bearings by preventing dirt from entering the hub.

3-3

Step 3, Detail 3

Decide whether the TrashWheels are to be run in the intersecting or offset position. This is a major decision affecting the behavior of the row cleaner.



Several factors influence this decision, but we suggest starting in the **\*\*OFFSET\*\*** position.

1. Running the TrashWheels in the intersecting position (both wheels in the middle hole on their side of the stem) is more aggressive and will be useful when large amounts of residue are to be moved and the row cleaner will be run deeper in the soil.
2. If you have **\*\*ANY\*\*** conventional tillage ground it is suggested that you use the offset position.
3. In the **\*\*OFFSET\*\*** position there are right and left hand units. **\*\*Above is shown a right hand unit.\*\*** The left is the mirror opposite. The rows on the right half of the planter take right hand units and the left hand units take lefts.

# 3-4

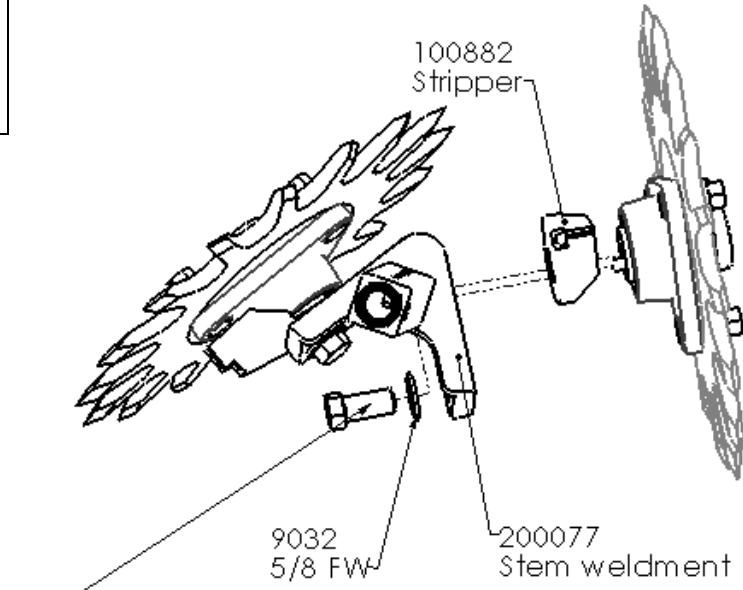

A 9101 5/8-11x1.5  
HHCS

A=9115  
Components "A"  
are included in 9115,  
hub hardware kit

Step 3, Detail 4

Bolt the Hub+TrashWheel  
assemblies onto the stem.

100 882 points up if in either of the  
front holes and straight back if in the  
rear hole.

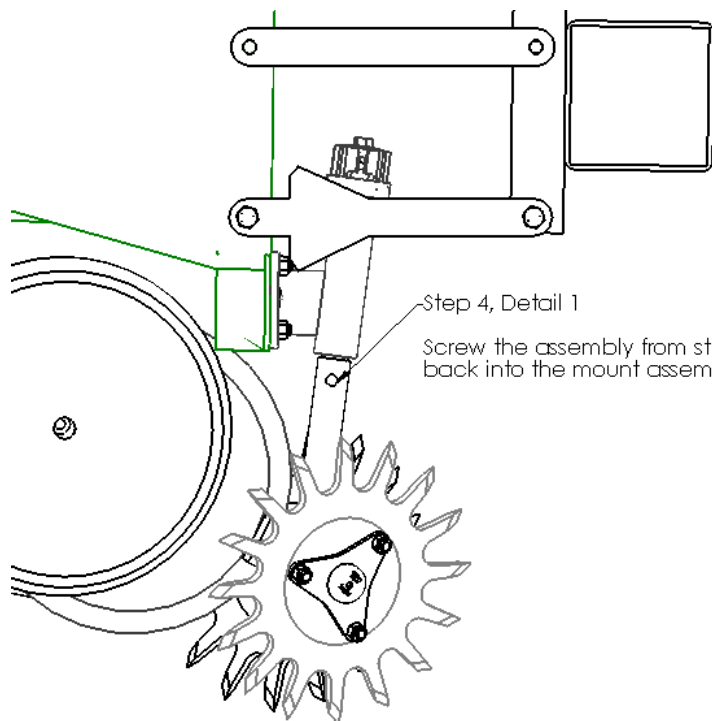

Step 4, Detail 1

Screw the assembly from step 3  
back into the mount assembly.

# 4-1

# 5

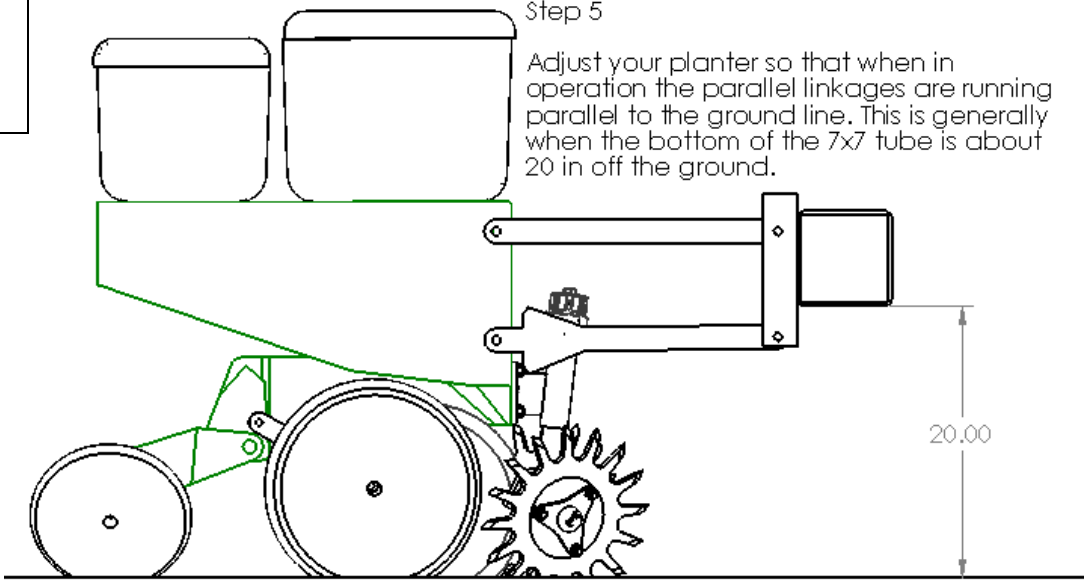

Use the DAWN Screw Adjust to place each unit so that only the teeth of the TrashWheel are in the ground (See Above). Usually if you run too deep you will plow a furrow. The teeth need to be far enough in the ground to keep them turning, especially when in the INTERSECTING position.

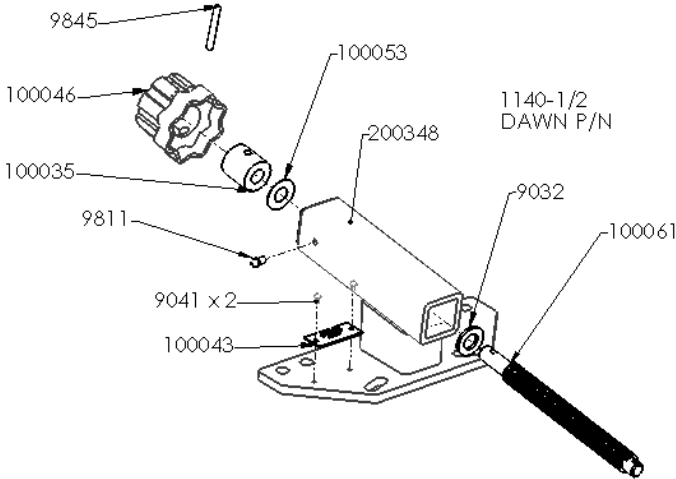

300 041  
DAWN P/N

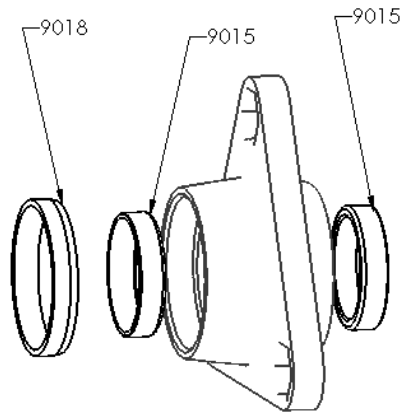

400 014 ASSY  
DAWN P/N

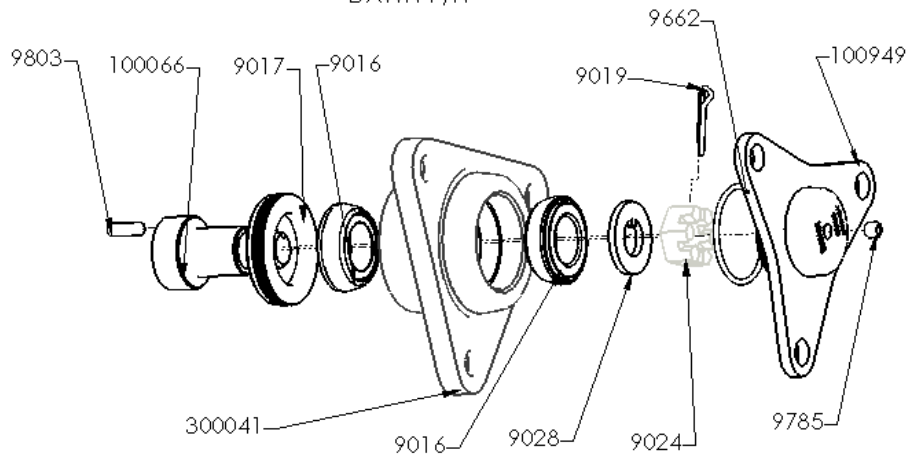

9806, grease fitting  
\*\*Remove and replace with  
plug when not in use\*\*



## DAWN LIMITED WARRANTY AGREEMENT

The following warranties with respect to new DAWN Equipment Company products, excepting as hereafter provided, is made by DAWN to Dealers ("Dealers") authorized by DAWN to sell the products involved and each selling Dealer, in turn, make such warranties to the original retail purchaser (the "purchaser").

### A. Duration and Extent of Warranty

1. Products, except all working, moving, moving and all or any parts subject to wear, except as hereafter provided, which are defective in materials or workmanship as delivered to the Purchaser by a Dealer will be repaired by a Dealer or replaced by DAWN, only, as DAWN elects, without charge for materials or labor, if such defect appears in not more than 12 months, or from and after the date of delivery to the Purchase by the Dealer.
2. Those working and moving parts consisting of Quick Lift, bearings and hub assemblies are warranted for repair or replacement as DAWN elects for a period not to exceed six month or 1,000 working hours, whichever comes first, from date of delivery to the Purchaser by Dealer.
3. DAWN warrants that the Trashwheels planter attachment Wheel (Dawn. #200-015) will not bend or break during its useful lifetime.
4. Liability of DAWN for defective parts or material is specifically limited to the value of the parts or materials, only.
5. All parts or materials requiring warranty work MUST be returned by delivery to the selling Dealer for repair or for deliver to DAWN within thirty (30) days of occurrence of the defect or failure of the part or material, all freight prepaid by the Dealer. Upon completion of the warranty work, DAWN will ship parts or material to Dealer, freight prepaid by DAWN.
6. All decisions by DAWN pertaining to warranty are final.

### B. Warranty Exclusions

DAWN will not be responsible for any of the following:

1. Defects or damage resulting from use, repairs or service performed in a manner not approved by DAWN or from repairs or service performed by someone other than an authorized DAWN Dealer service department (after approval from DAWN) or DAWN to repair or replace the product involved.
2. Defects, damage or failure resulting from any alteration or additions done in a manner not approved by DAWN.
3. Defects, damage or failure or depreciation resulting from wear and tear, accident, misuse, negligence, improper maintenance or improper protection and storage.
4. INCIDENTAL OR CONSEQUENTIAL DAMAGES, INCLUDING BUT NOT LIMITED TO, LOSS OF PROFITS, LOSS OF TIME, LOSS OF CROPS, INCONVENIENCE, LOSS OF USE OF THE PRODUCT OR OTHER MACHINERY, EQUIPMENT OR VEHICLE USED WITH THE PRODUCTS, COST OF RENTALS OR REPLACEMENT OF THE PRODUCTS OR OTHER COMMERCIAL LOSS.

### C. Remedies Exclusive: NO Other Warranties

The obligations of DAWN and the Dealers are limited to the obligations set forth in this Limited Warranty. THIS LIMITED WARRANTY IS IN LIEU OF ALL OTHER WARRANTIES OF DAWN, AND THE DEALERS, EXPRESSED OR IMPLIED. WARRANTIES BY DAWN OR THE DEALER OF CONDITION QUALITY, MERCHANTABILITY OR FITNESS FOR A PARTICULAR PURPOSE ARE EXCLUDED, AS ARE AL OTHER REPRESENTATIONS

BY DAWN AND THE DEALERS TO THE PURCHASE OR USER AND ALL OTHER OBLIGATIONS OR LIABILITIES OF DAWN AND THE DEALERS. NO OTHER PERSON IS AUTHORIZED TO GIVE ANY OTHER WARRANTY OR TO ASSUME ANY OTHER LIABILITY ON BEHALF OF DAWN OR THE DEALERS. THIS LIMITED WARRANTY MAY NOT BE TRANSFERRED BY THE PURCHASER TO ANY SUBSEQUENT OWNER.

D. The instruction manual supplied with the Product contains important maintenance and service information. Read the manual and follow the recommendations contained herein. Please remember that failures due to improper maintenance or service are not covered by the Limited Warranty.

DAWN Equipment Company reserves the right to make changes in design or specifications at any time without obligation to purchasers or equipment and components previously sold. This warranty shall not be altered or changed in any way.

©1995 (8035 Rev. 1, Nov. 1994), DAWN Eq. Company P.O.Box 497, 370 North Cross,  
Sycamore, IL 60178

